

Main features of beaver threading machine series

**THE MACHINES DESIGNED TO THREAD,
"DURABLE THREAD FOR HIGH PRESSURE AND AIRTIGHT THREADING".**

Purpose

For Water, Gas, Electricity Pipe threading and Stainless Steel Pipe threading and also for Bolt threading.

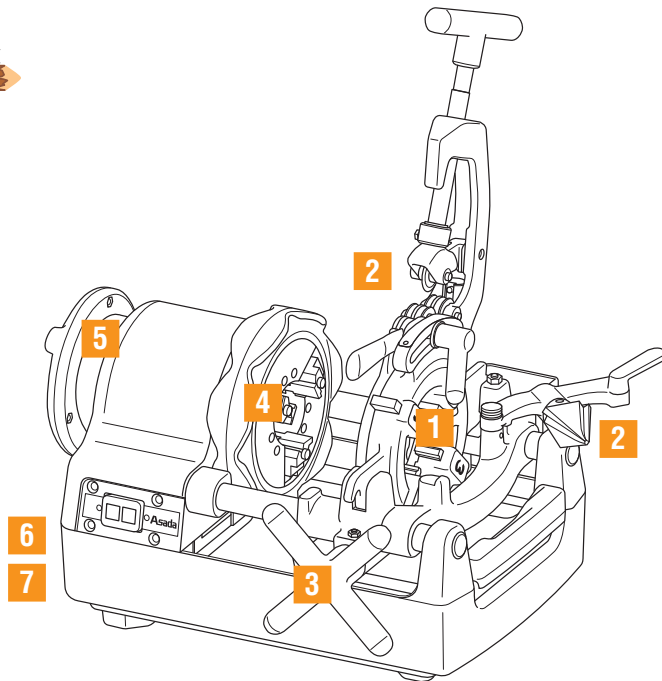
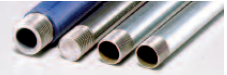

1 Automatic die head and dies

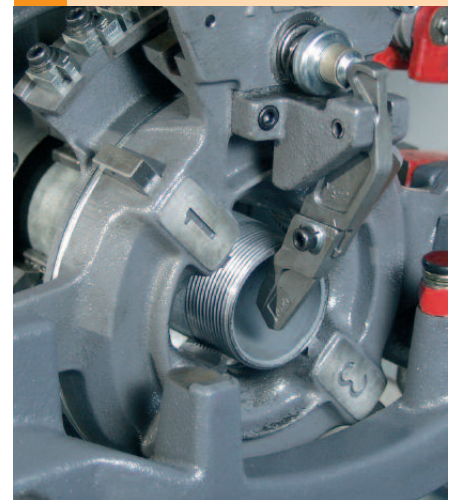

- Die head equipped with automatic profiling system and designed to reduce cut resistance for precise threads.
- Dies made of special pre-heat treated steel, ensuring long life and easy threading.

2 Cutter blade and reamer blade

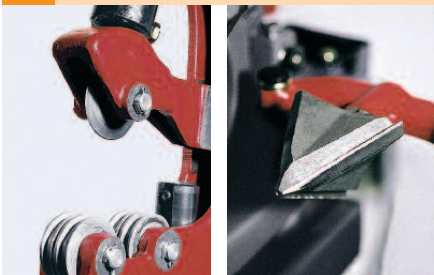

- Designed for Beaver series, with the most suitable shaped blade tip allows for sharp cut and durability.

3 Rack handle



- Can be easily gripped for smooth operation.

4 Hammer chuck



- Outer ring designed to grip easily and to grab pipes firmly with less power.
- The Jaw Body is wider giving greater load capacity and durability.
- Jaw Insert improves the centripetal clamping feature.

5 Spindle support



- Spindle is supported by Sealed Ball Bearing, ensuring correct alignment and continued accuracy through lack of wear.

6 Powerful electric motor



- Class F insulation grade on the motor allows continuous operation.
- More than sufficient Horse Power; Beaver 50 - 750W, Beaver 80 & 100 - 1,140W

7 Cutting oil pump

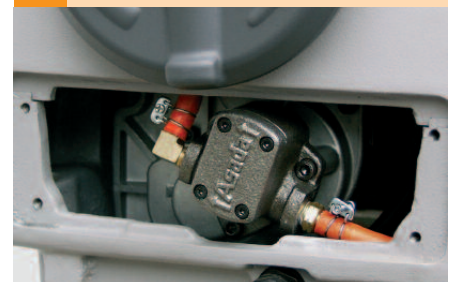

- The high capacity Gear Pump operates even at low revolutions to assure precise threads.

Beaver 80

PAT.

1/4 ~ 3"

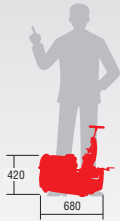

- Equipped powerful motor of 1140W.
- Maintenance free ball bearing protects spindle support from abrasion.
- Easily grabbed handle provides for active operation.
- High capacity oil pump keeps enough oil even at low rotation, assuring precise threads.

| Model | Beaver80 | Beaver 80AT | Beaver80ATII | Beaver80 ATII-MN (with Circular saw) |
|----------------------|---|--|--|---|
| Code No. | BE800 | BE8AT | BE8AA | BE8AM |
| Threading capacity | Water/Gas pipe 1/4 ~ 3" | | | |
| | Bolt 3/8 ~ 2" 10 ~ 36mm | | | |
| | Conduit 19 ~ 75mm 1/2 ~ 3" | | | |
| Weight | 74kg | | | 73kg |
| Spindle Speed | 33 rpm (No load) | | | |
| Motor | 100V (Voltage made to order) 1140W 50/60Hz | | | |
| Dimensions | (L)680x (W)480 x (H)420mm | | | |
| Standard Accessories | Die-Head | Manual 1/2 ~ 2" Manual 2 ~ 3" | Auto. 1/2 ~ 2" Auto. AT2.1/2 ~ 3" | Auto. 1/2 ~ 3/4", Auto. AT1 ~ 2" Auto. AT2.1/2 ~ 3" |
| | Dies | BE1/2 ~ 3/4" BE1 ~ 1.1/2"(2") AT2 ~ 3" | BE1/2 ~ 3/4" BE1 ~ 1.1/2"(2") AT2.1/2 ~ 3" | BE1/2 ~ 3/4" BE1 ~ 1.1/2"(2") AT2.1/2 ~ 3" |
| Others | Threading oil white 4 lit.(1can), Machine Cover, Legs | | | |

| Main Applicable Die-Head | | | |
|--------------------------|------------|-----------------------|------------|
| Type | Item | Size | Code No. |
| Beaver (Auto) | BSPT | BE1/2 ~ 2" | BE001 |
| | | NPT | BE01N |
| | BSPT | AT2.1/2 ~ 3" | 52200 |
| | | AT2.1/2 ~ 4" | 64200 |
| Auto | NPT | AT2.1/2 ~ 3" | 52600 |
| | | AT2.1/2 ~ 4" | 64350 |
| | BSPT (BSW) | 1/4 ~ 3/8" (3/8 ~ 1") | 20114 |
| | | NPT | 1/4 ~ 3/8" |
| Manual | BSPT/NPT | 1/2 ~ 2" | 63090 |
| | | 2 ~ 3" | 20127 |
| | BPST | 3.1/2 ~ 4" | 04110 |

Beaver 100

PAT.

1/4 ~ 4"



- Equipped powerful motor of 1140W.
- Maintenance free ball bearing protects spindle support from abrasion.
- Easily grabbed handle provides for active operation.
- High capacity oil pump keeps enough oil even at low rotation, assuring precise threads.
- 2 stage speed system helps to cut off any sizes of pipe.

| Model | Beaver100ATII | Beaver100ATII-MN (with Circular saw) |
|----------------------|--|--|
| Code No. | BE1AT | BE1AM |
| Threading capacity | Water/Gas pipe 1/4 ~ 4" | |
| | Bolt 3/8 ~ 2" 10 ~ 36mm | |
| | Conduit 19 ~ 75mm 1/2 ~ 3" | |
| Weight | 105kg | 103kg |
| Spindle Speed | 48- 18 rpm (2 speed) (No load) | |
| Motor | 100V (Voltage made to order) 1140W 50/60Hz | |
| Dimensions | (L)790 x (W)570 x (H)480mm | |
| Standard Accessories | Die-Head | Auto.1/2 ~ 2", Auto.AT2.1/2 ~ 4" |
| | Dies | BE1/2 ~ 3/4", BE1 ~ 1.1/2"(2"), AT2.1/2-4" |
| Others | Threading oil, white, 4 lit.(1 can), Machine Cover, Legs | |

| Main Applicable Dies | | | |
|----------------------|------------|-----------------|----------|
| Type | Item | Size | Code No. |
| Automatic | BSPT | M/AT 1/2 ~ 3/4" | 89211 |
| | | BE 1/2 ~ 3/4" | 89266 |
| | | M/AT 1 ~ 2" | 89227 |
| | | BE 1 ~ 2" | 89267 |
| | NPT | AT 2.1/2 ~ 3" | 89228 |
| | | AT 2.1/2 ~ 4" | 59803 |
| | | M/AT 1/2 ~ 3/4" | 89101 |
| | | M/AT 1 ~ 2" | 89102 |
| | | AT 2.1/2 ~ 3" | 89245 |
| | | AT 3.1/2 ~ 4" | 89246 |
| Manual | BSPT | 1/4 ~ 3/8" | 89046 |
| | | M/AT 1/2 ~ 3/4" | 89211 |
| | | BE 1/2 ~ 3/4" | 89266 |
| | | M/AT 1 ~ 2" | 89227 |
| | NPT | BE 1 ~ 2" | 89267 |
| | | 2 ~ 3" | 89051 |
| | | 3.1/2 ~ 4" | 89052 |
| | | 1/4 ~ 3/8" | 89100 |
| | | M/AT 1/2 ~ 3/4" | 89101 |
| | | M/AT 1 ~ 2" | 89102 |
| | 2.1/2 ~ 3" | 89258 | |