

Main features of beaver threading machine series

**THE MACHINES DESIGNED TO THREAD,
"DURABLE THREAD FOR HIGH PRESSURE AND AIRTIGHT THREADING".**

Purpose

For Water, Gas, Electricity Pipe threading and Stainless Steel Pipe threading and also for Bolt threading.

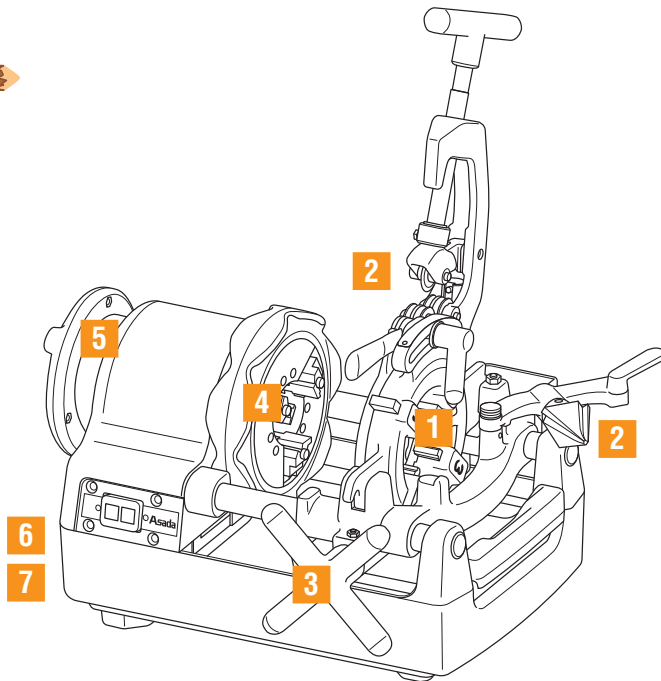
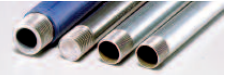

1 Automatic die head and dies

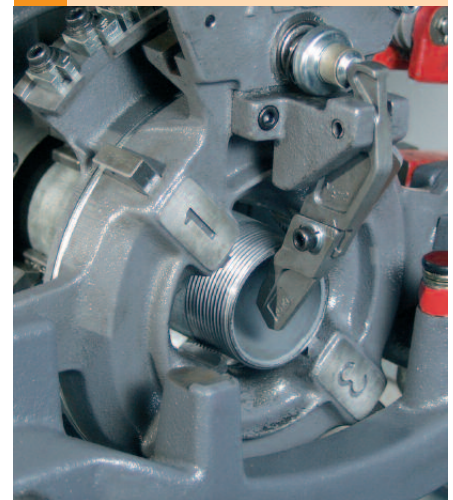

- Die head equipped with automatic profiling system and designed to reduce cut resistance for precise threads.
- Dies made of special pre-heat treated steel, ensuring long life and easy threading.

2 Cutter blade and reamer blade

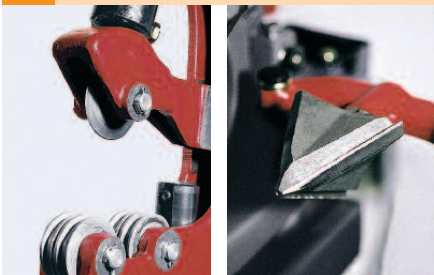

- Designed for Beaver series, with the most suitable shaped blade tip allows for sharp cut and durability.

3 Rack handle



- Can be easily gripped for smooth operation.

4 Hammer chuck



- Outer ring designed to grip easily and to grab pipes firmly with less power.
- The Jaw Body is wider giving greater load capacity and durability.
- Jaw Insert improves the centripetal clamping feature.

5 Spindle support



- Spindle is supported by Sealed Ball Bearing, ensuring correct alignment and continued accuracy through lack of wear.

6 Powerful electric motor



- Class F insulation grade on the motor allows continuous operation.
- More than sufficient Horse Power; Beaver 50 - 750W, Beaver 80 & 100 - 1,140W

7 Cutting oil pump



- The high capacity Gear Pump operates even at low revolutions to assure precise threads.

Beaver 25

PAT.

1/4 ~ 1"



- Equipped powerful motor of 350W.
- Spindle is supported by Sealed Ball Bearing to prevent from abrasion.
- The high capacity Gear Pump operates even at low revolutions to assure precise threads.

Model	Beaver 25	Beaver 25-MN (with circular saw)
Code No.	BE25B	BE25M
Threading capacity	1/4 ~ 1"	
Water/Gas pipe	1/4 ~ 1"	
Bolt	3/8 ~ 1" M10 ~ 24mm	
Conduit	19 ~ 39mm 1/2 ~ 1"	
Weight	19kg	22kg
Spindle Speed	52 rpm (No load)	
Motor	100V (Voltage made to order) 350W 50/60Hz	
Dimensions	(L)400 x (W)317 x (H)320mm	
Standard Accessories	Die Head Automatic 1/2 ~ 1" Dies AM1/2" ~ 3/4", AM1" ~ 1.1/2" Others Threading oil white 1lit.(1can), Machine Cover	

Main Applicable Die-Head			
Type	Standard	Size	Code No.
Beaver (Auto)	BSPT	BE1/2 ~ 1"	BE380
	NPT	BE1/2 ~ 1"	BE389
Manual	BSPT (BSW)	1/4 ~ 3/8" (3/8 ~ 1")	AS109
	NPT	1/4 ~ 3/8"	AS122

Main Applicable Dies			
Type	Standard	Size	Code No.
Auto	BSPT	AM 1/2 ~ 3/4"	AS086
		AM 1 ~ 1.1/2"	AS087
	NPT	AM 1/2 ~ 3/4"	AS120
		AM 1 ~ 1.1/2"	AS121
Manual	BSPT	1/4 ~ 3/8"	89046
	NPT	1/4 ~ 3/8"	89100

Beaver 50

PAT.

1/4 ~ 2"



- Equipped powerful motor of 750W.
- Maintenance free ball bearing protects spindle support from abrasion.
- High capacity oil pump keeps enough oil even at low rotation, assuring precise threads.

Model	Beaver50	Beaver 50AT	Beaver50ATII	Beaver50ATII-MN (with Circular saw)
Code No.	BE511	BE5AT	BE5AA	BE5AM
Threading capacity	1/4 ~ 2"			
Water/Gas pipe	1/4 ~ 2"			
Bolt	3/8 ~ 2" 10 ~ 36mm			
Conduit	19 ~ 51mm 1/2 ~ 2"			
Weight	44kg			
Spindle Speed	40 rpm (No load)			
Motor	100V (Voltage made to order) 750W 50/60Hz			
Dimensions	(L)535 x (W)430 x (H)340mm			
Standard Accessories	Die-Head	Manual 1/2 ~ 2"	Auto.1/2 ~ 2"	Auto.1/2 ~ 3/4", Auto.AT1 ~ 2"
Dies	BE1/2 ~ 3/4"	BE1/2 ~ 3/4"	BE1/2 ~ 3/4"	
	BE1 ~ 1.1/2'(2)"	BE1 ~ 1.1/2'(2)"	BE1 ~ 1.1/2'(2)"	
Others	Threading oil white 4 lit.(1can), Machine Cover, Legs			

Main Applicable Die-Head			
Type	Standard	Size	Code No.
Beaver (Auto)	BSPT	BE1/2 ~ 2"	BE001
	NPT	BE1/2 ~ 2"	BE01N
Manual	BSPT (BSW)	1/4 ~ 3/8" (3/8 ~ 1")	20114
	NPT	1/4 ~ 3/8"	20165
	BSPT / NPT	1/2 ~ 2"	63090

Main Applicable Dies			
Type	Standard	Size	Code No.
Auto	BSPT	M/AT 1/2 ~ 3/4"	89211
		BE 1/2 ~ 3/4"	89266
		M/AT 1 ~ 2"	89227
		BE 1 ~ 2"	89267
Manual	BSPT	M/AT 1/2 ~ 3/4"	89101
		M/AT 1 ~ 2"	89102
		1/4 ~ 3/8"	89046
		M/AT 1/2 ~ 3/4"	89211
Manual	NPT	BE 1/2 ~ 3/4"	89266
		M/AT 1 ~ 2"	89227
		BE 1 ~ 2"	89267
		1/4 ~ 3/8"	89100
Manual	NPT	M/AT 1/2 ~ 3/4"	89101
		M/AT 1 ~ 2"	89102